

REV	DESCRIPTION	DESIGN	DATE
A0	NEW RELEASE	FangSongLe	2019/07/13

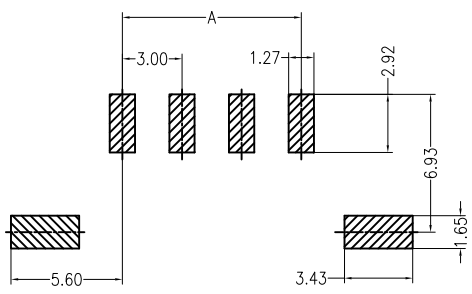

PCB LAYOUT(Tolerance:±0.05)

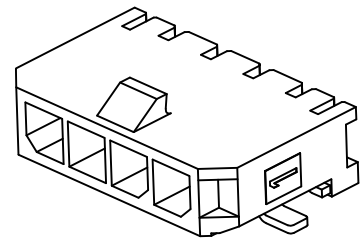
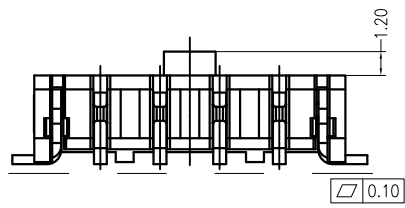
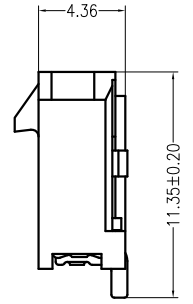
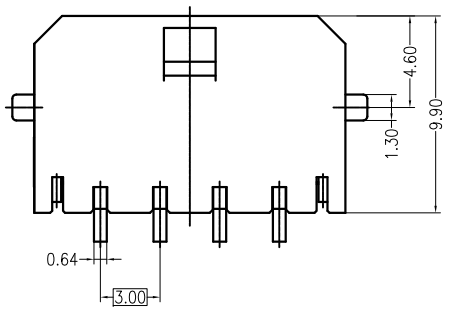
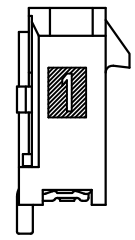
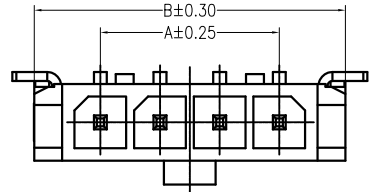
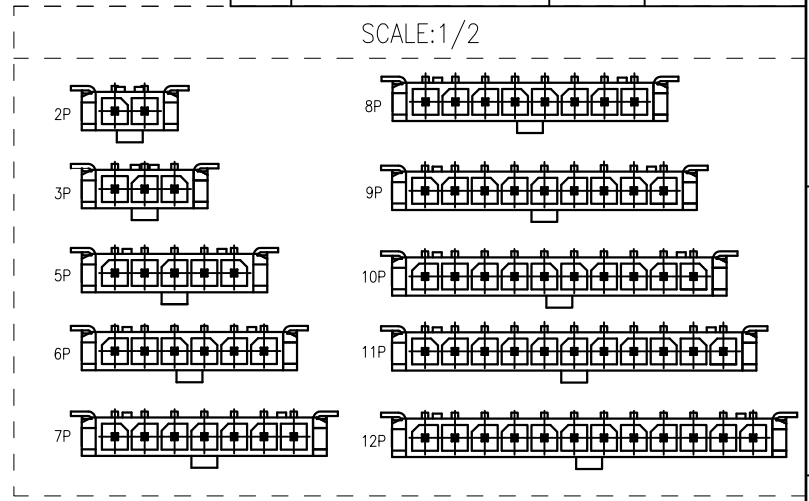

Specifications:

- Contact resistance: ≤10mΩ
- Insulation resistance: ≥1000MΩ
- Rated voltage: 250V AC DC
- Rated current: 5.0A AC DC
- Withstand Voltage: 1000V AC/minute
- Temperature Range: -25℃ ~ +85℃
- Housing: LCP UL94V-0, BLACK
- Contacts: Brass/MATTE Sn-plated
- Solder Tabs: Brass/MATTE Sn-plated

PIN	DIM A	DIM B
2	3.00	9.65
3	6.00	12.65
4	9.00	15.65
5	12.00	18.65
6	15.00	21.65
7	18.00	24.65
8	21.00	27.65
*9	24.00	30.65
*10	27.00	33.65
*11	30.00	36.65
*12	33.00	39.65

ORDER INFORMATION:

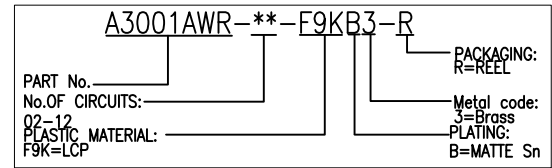

JKUN 温州健坤接插件有限公司 WENZHOU JKUN CONNECTOR CO.,LTD.		TITLE: 3.0 Pitch Wafer 90° SMT	
GENERAL TOLERANCE		USE: CUSTOMER	PART NO.:
X. ±0.50	X. ±5°	APPD: Liuzhengling	A3001AWR-**-F9KB3-R
X.X ±0.30	X.X ±2°	CHKD: Steven	DWG NO.:
X.XX ±0.20	X.XX ±1°	DR: FangSongLe	JKUN-GCKH-0632
⊕	UNITS: mm	SCALE 1 : 1	SHEET 1 / 1